

55M FAST OFFSHORE SUPPLY VESSEL

NAVAS CORPORATION

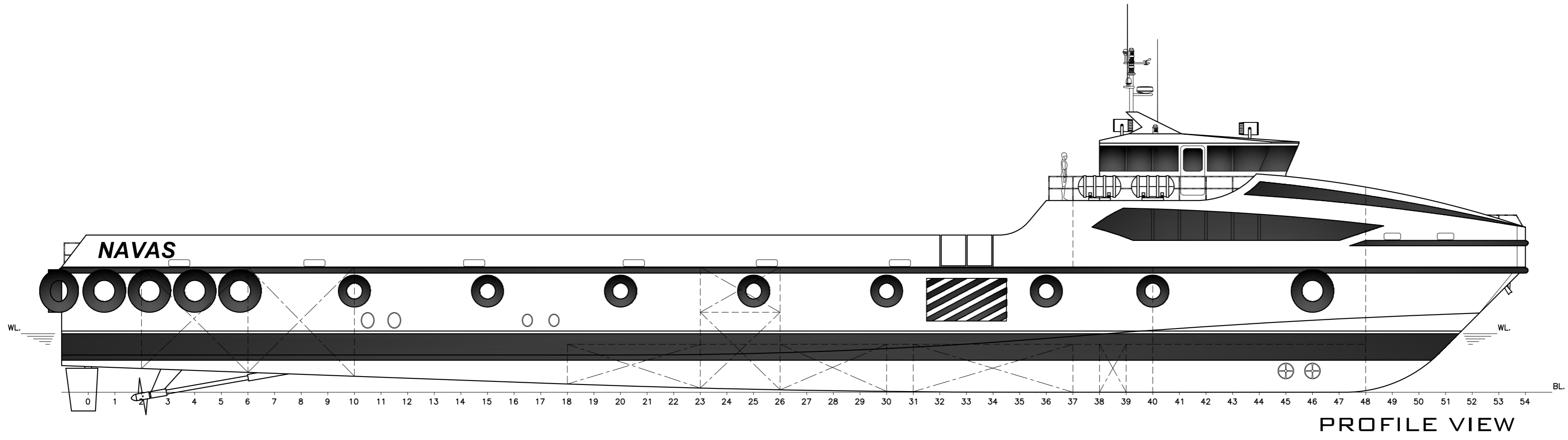

PROFILE VIEW

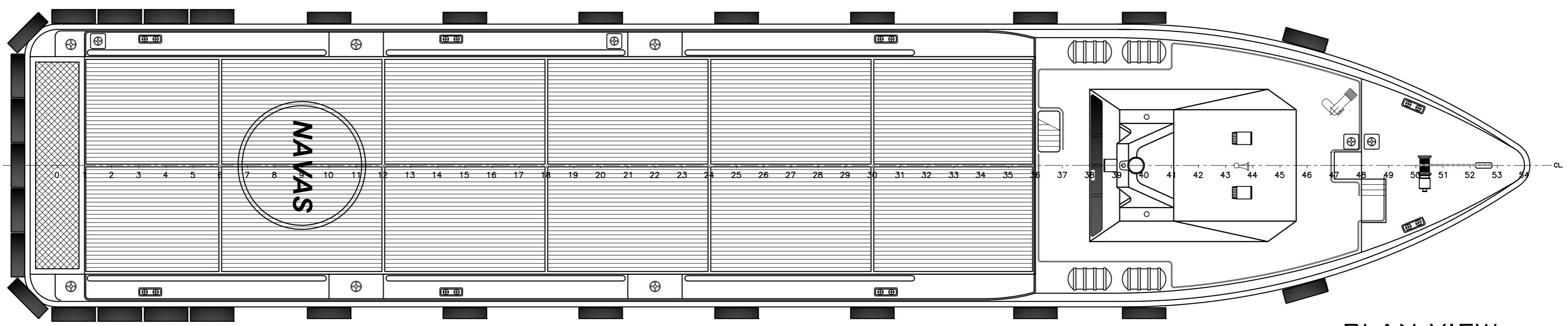

PLAN VIEW

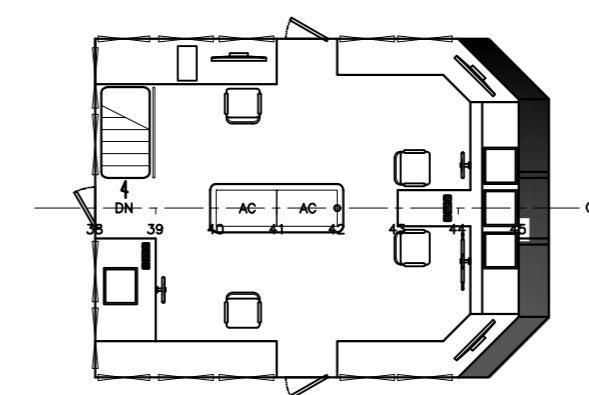

BRIDGE DECK PLAN

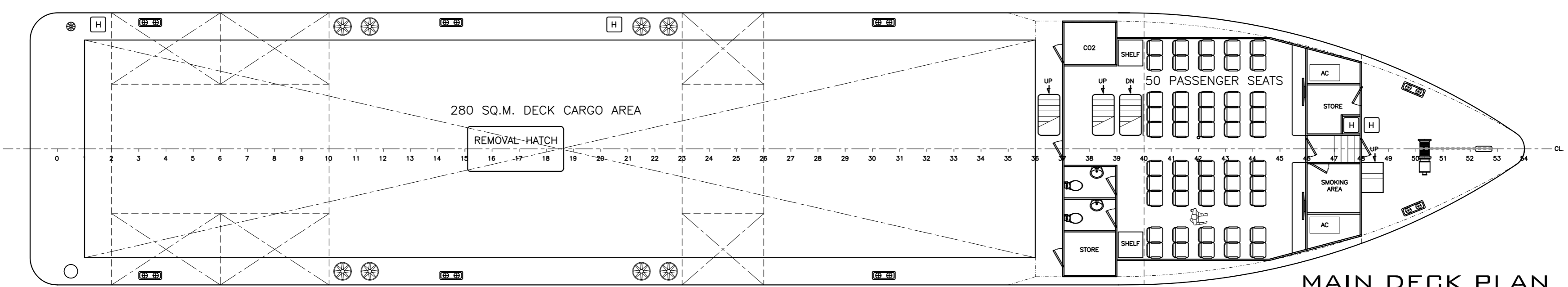

MAIN DECK PLAN

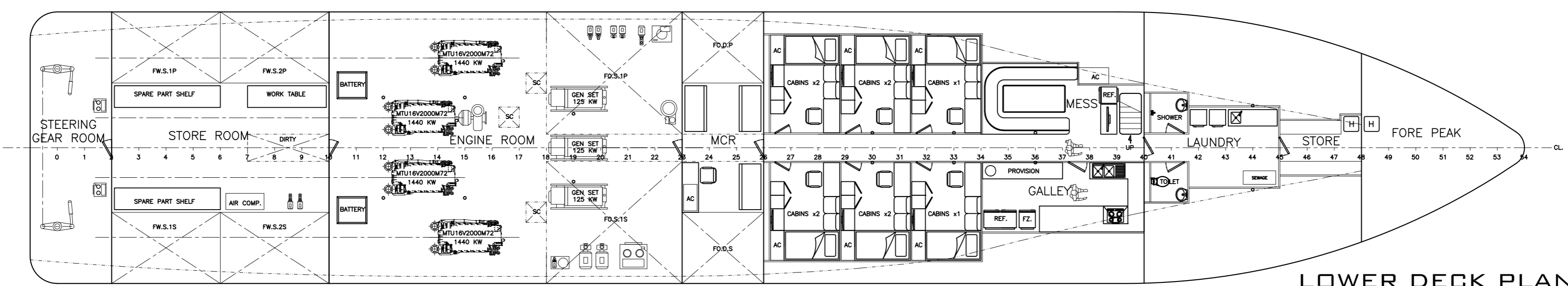

LOWER DECK PLAN

TECHNICAL SPECIFICATION

DIMENSIONS

LENGTH OVERALL	55.00	M.
LENGTH BP	51.50	M.
BREADTH	10.00	M.
DEPTH	4.70	M.
DRAFT DESIGN	1.60	M.
DRAFT SCANTLING	2.20	M.

CAPACITIES

CREWS	10	PERSONS
PASSENGER	50	PERSONS
FUEL OIL	120	CU.M.
FRESH WATER	140	CU.M.
DECK CARGO AREA	280	SQ.M.
DECK CARGO LOAD	200	TON
	5	TON/SQ.M.

PERFORMANCE

MAXIMUM SPEED	30	KNOTS
CRUISING SPEED	20	KNOTS
ENDURANCE	7	DAYS

MACHINERY

MAIN ENGINES	4xMTU16V2000M72
TOTAL POWER	5760 KW
GEAR BOXES	4xZF5000
PROPULSION	4xFPP
BOW THRUSTER	2x1.5 TONS

ELECTRICAL SYSTEM

NETWORK	24VDC/230VAC/400VAC
GENERATOR	3x125 KW, 400VAC/50HZ/3PH

NAVAS CORPORATION

12/23 NGAMWONGWAN ROAD, SOI 59 LANE 3-7, LADYAO, CHATUCHAK, BANGKOK 10900

EMAIL : WITTAUAT.LON@GMAIL.COM, TEL.+66 (0) 89811 2556